

Allright ger både uppljus och nedljus genom det prismatiska bländskyddet. Monteras på vägg i korridor, trapphus mm.

Utförande: Naturanodiserad aluminium, natur, mörkgrå- eller bronslackerad. Bländskydd av prismatisk akryl.

Montage: På vägg.

Anslutning: Kopplingsplint 3x4mm².

Design: Per Sundstedt.

W	B/MM	IP	KG	ART
1x18W/Gx24q-2	268	IP20	1,6	7413-1-XX
2x18W/Gx24q-2	365	IP20	1,9	7413-3-XX
1x32W/Gx24q-3	365	IP20	1,9	7413-3-XXHFF
LED	365	IP20	1,9	7426-3-XX

XX = Färg/Color -38 Aluminium, -97 Brons/Bronze, -98 Mörkgrå/Dark grey.

HFF = Dimmbart med DALI, DSI, SwitchDim

HFF = Dimmable with DALI, DSI, SwitchDim

LED* se www.zero.se för teknisk information gällande Led.

LED* visit www.zero.se for technical information regarding LED.

TILLBEHÖR/ACCESSORY

Vitt täcklock för endast nedljus bredd 268 mm. **97413-1-01**

Cover for downlight width 268 mm.

Vitt täcklock för endast nedljus bredd 365 mm. **97413-3-01**

Cover for downlight width 365 mm.

Finish: Anodized aluminium, natural, bronze or dark grey painted and white painted steel. Diffuser in prismatic acrylic.

Installation: Wall installation.

Connection: Terminal block 3x4mm².

Design: Per Sundstedt.

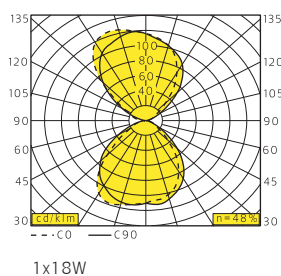
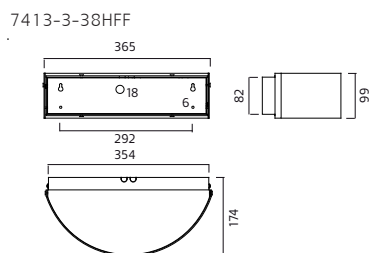
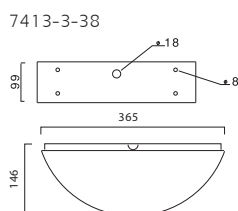
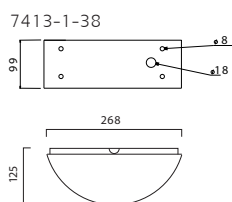

1x18W

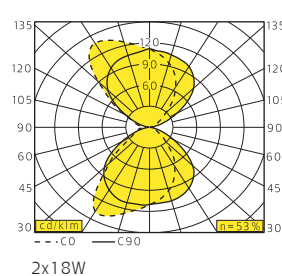

2x18W



TAK/CEILING 24

VÄGG/WALL 125