

PNC Park, Pittsburg, Pennsylvania, USA. Architect: Ross Murphy Finkelstein. Photo: Jack Wolff Photography

**Weblink**  
1460

**Design**  
LK as

**Concept**

Skot Maxi Wall/Ceiling provides both direct and diffuse lighting with a choice of either clear or white opal diffuser. The half-masked crossguard accentuates the downlight.

**Finish**

Aluminium coloured or graphite with textured surface, powder coated.

**Material**

Diffuser: Injection moulded clear polycarbonate or injection moulded opal polycarbonate. Base/cross guard: Die cast aluminium.

**Mounting**

Terminal block: 1x5x6mm<sup>2</sup>. Cable entries: 6x rear entries. 3x knockout entries in each side. Looping: Approved, max. 4x2,5mm<sup>2</sup>. Ballast positioning: In wall box.

**Weight**

Max. 7.5kg.

**Class**

Ingress protection IP66. Electric shock protection II w/o ground. Vandal Proof II. ▽

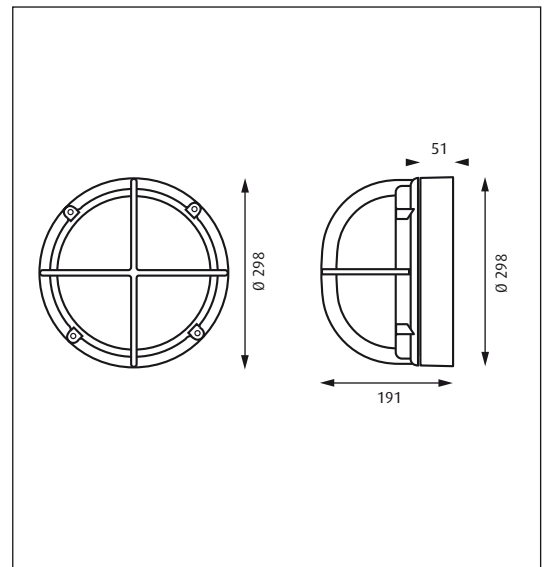

Product code	Light source	Finish	Shield/Diffuser
SKT-MA-WC	1x26W TC-DEL G24q-3 HF 1x42W TC-TEL GX24q-4 HF 1x80W HME E27 Conv.	ALU COL GRAPH TEXT	HALF SHADED CLEAR HALF SHADED OPAL OPAL

Info notes:  
The HME-version is not phase-compensated as standard. A phase-compensation unit is to be ordered seperately.

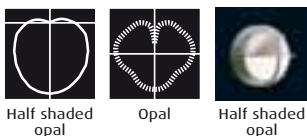

Half shaded  
opal

Opal

Half shaded  
opal



Page 157

Page 176

Page 177